

## Cast Iron Inverted Bucket Steam Trap

### Features

1. Cast iron body and stainless steel internals.
2. Efficient energy conservation: will not leak live steam and prevents steam loss by the water seal inside the bucket.
3. No air and steam locking.
4. Very high durability by using the MIYAWAKI super lever and **SCCV** – System.
5. Withstands high back pressure (up to 90 % of the inlet pressure).
6. Withstands vibration.
7. Easy maintenance – all internal parts can be taken out together with the cover.

**ES 12**

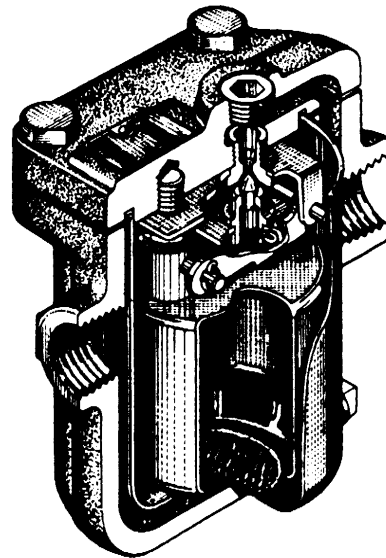

### Operating Conditions & Dimensions

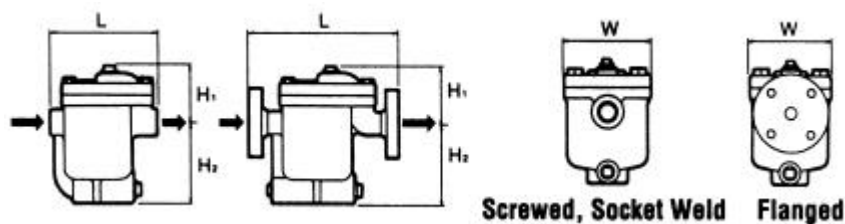

Model	Connection	Size	Operating Pressure Range		Max. Operating Temperature		Dimension mm (inch)				Weight	
			MPa	psig	°C	°F	L	H <sub>1</sub>	H <sub>2</sub>	W	kg	lb
ES 12N	flanged JIS, ANSI, DIN	½" – 1"	1,6	230	220	428	270 (10.6)	140 (5.5)	140 (5.5)	120 (4.7)	13,5	29.7
		1¼"–2"					280 (11.0)	150 (5.9)	130 (5.1)			

## Cast Iron Inverted Bucket Steam Trap

# ES 12

### Details

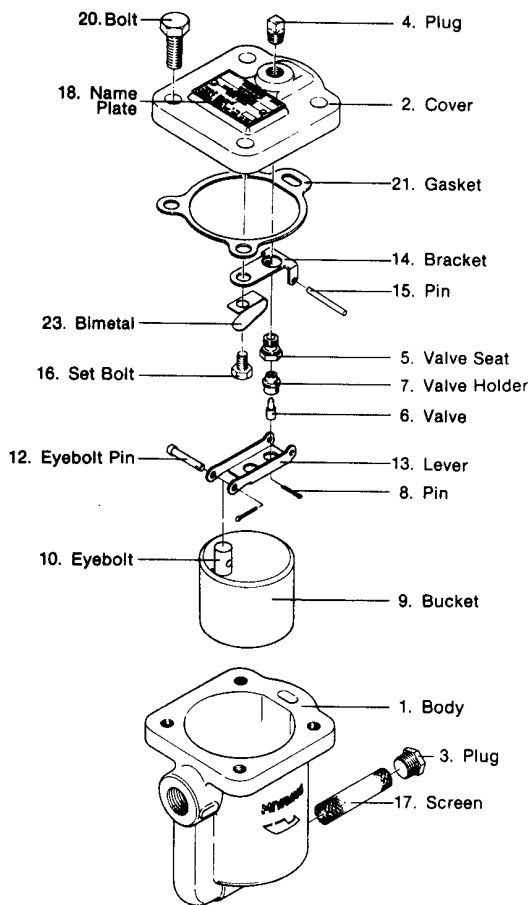

### Capacity Chart

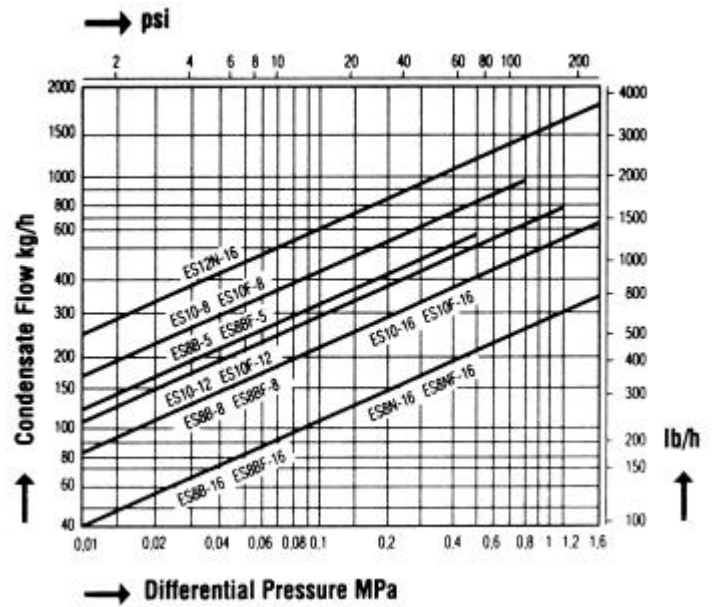

### Materials

Parts-No.	Name	Material JIS/ASTM
1	Body	FC 250
2	Cover	FC 250
5	Seat	SUS 440C
6	Valve	STL No. 6B
7	Valve holder	SUS 303
9	Bucket	SUS 316
11, 13	Lever	SUS 304
17	Screen	SUS 304
20, 22	Bolts	SS400
21, 25	Gaskets	asbestos free