

## Ductile Cast Iron Inverted Bucket Steam Trap

### Features

1. Ductile cast iron body and stainless steel internals.
2. Efficient energy conservation: will not leak live steam and prevents steam loss by the water seal inside the bucket.
3. No air and steam locking.
4. Very high durability by using the MIYAWAKI super lever and **SCCV** – System.
5. Withstands high back pressure (up to 90 % of the inlet pressure).
6. Withstands vibration.
7. Easy maintenance – all internal parts can be taken out together with the cover.

### ES 8N

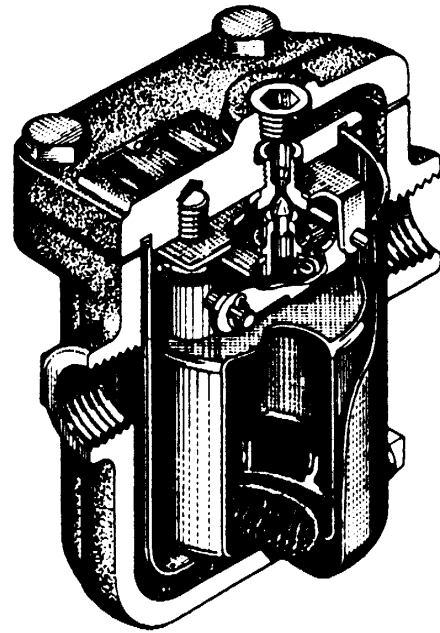

### Operating Conditions & Dimensions

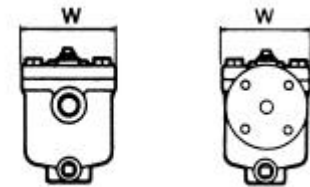
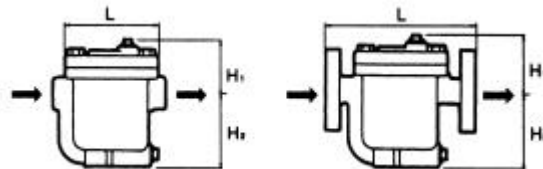

Screwed, Socket Weld Flanged

Model	Connection	Size	Operating Pressure Range		Max. Operating Temperature		Dimension mm (inch)				Weight	
			MPa	psig	°C	°F	L	H <sub>1</sub>	H <sub>2</sub>	W	kg	lb
ES 8N	screwed Rc, NPT	½	1,6	230	350	662	130 (5.1)	73 (2.9)	90 (3.5)	100 (3.9)	3,7	8.2
		¾										
		1"					3,9	8.6				
ES 8NF	flanged JIS, ANSI, DIN	½	1,6	230	350	662	175 (6.9)	73 (2.9)	90 (3.5)	100 (3.9)	5,3	11.7
		¾					7,7					
		1"					8,5	6,8	15.0			

## Ductile Cast Iron Inverted Bucket Steam Trap

Capacity Chart

# ES 8N

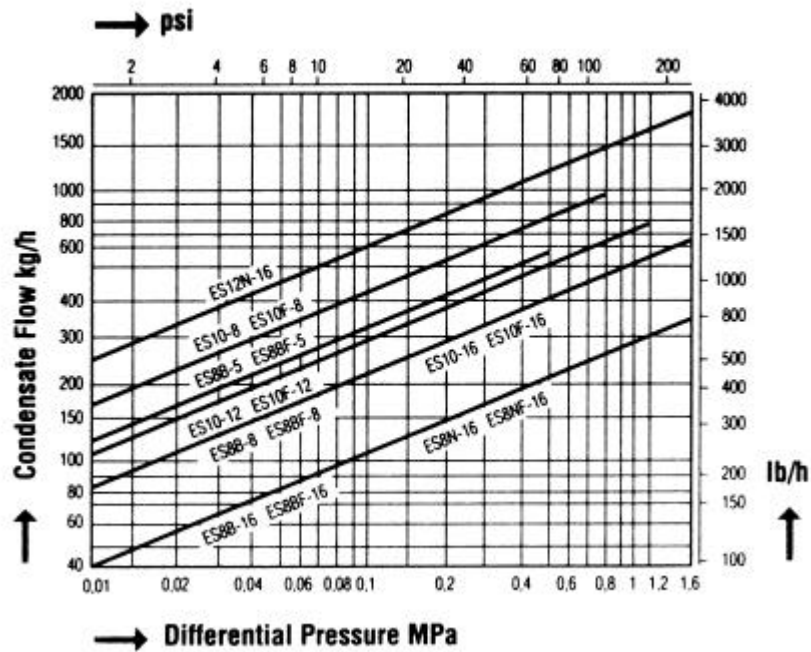

### Details

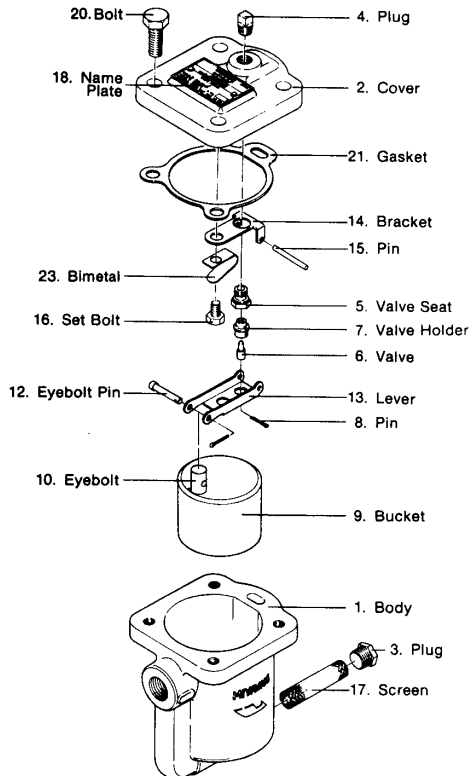

Depending on the max. oper. pressure the following types are available:

Model	Max. Oper. Pressure	
	MPa	psig
ES 8N - 5	0,5	73
ES 8N - 8	0,8	116
ES 8N - 16	1,6	230

### Materials

Parts-No.	Name	Material JIS/ASTM
1	Body	FCD 450
2	Cover	FCD 450
5	Seat	SUS 304
6	Valve	SUS 303
7	Valve holder	SUS 303
9	Bucket	SUS 316
13	Lever	SUS 304
17	Screen	SUS 304
20	Bolts	S45C
11, 21	Gaskets	asbestos free