

Cast Steel Inverted Bucket Steam Trap

Features

1. Cast Steel body and stainless steel internals for high pressure applications.
2. Efficient energy conservation: will not leak live steam and prevents steam loss by the water seal inside the bucket.
3. No air and steam locking.
4. Very high durability by using the MIYAWAKI super lever and **SCCV** – System.
5. Withstands high back pressure (up to 90 % of the inlet pressure).
6. Withstands vibration.
7. Easy maintenance – all internal parts can be taken out together with the cover.

ESH 21

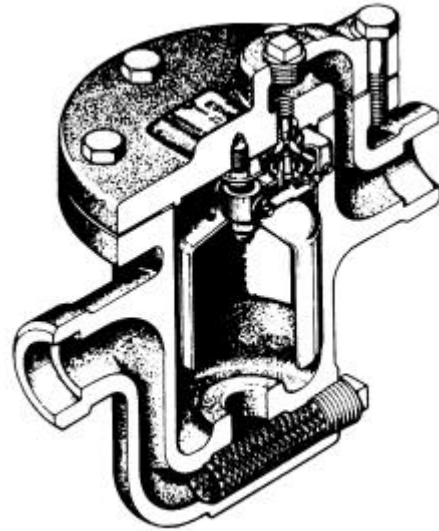

Operating Conditions & Dimensions

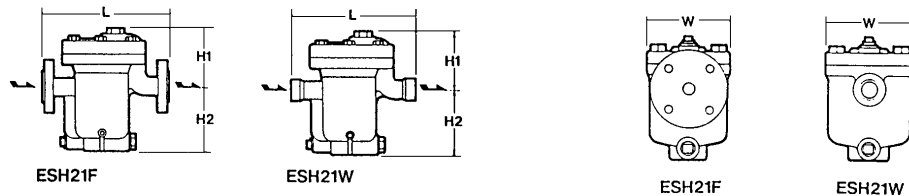

Model	Conne- ction	Size	Operating Pressure Range		Max. Operating Temperature		Dimension mm (inch)				Weight	
			MPa	psig	°C	°F	L	H ₁	H ₂	W	kg	lb
ESH21F-21	flanged JIS,ANSI DIN	½" – 1"	2,1	300	400	752	350 (13.8)	145 (5.7)	160 (6.3)	205 (8.1)	31,0	68.2
ESH21F-45			4,4	640							28,0	61.6
ESH21W-21	socket weld JIS,ANSI DIN	½" – 1"	2,1	300			300 (11.8)	145 (5.7)	160 (6.3)	205 (8.1)	28,0	61.6
ESH21W-45			4,4	640								

Cast Steel Inverted Bucket Steam Trap

ESH 21

Details

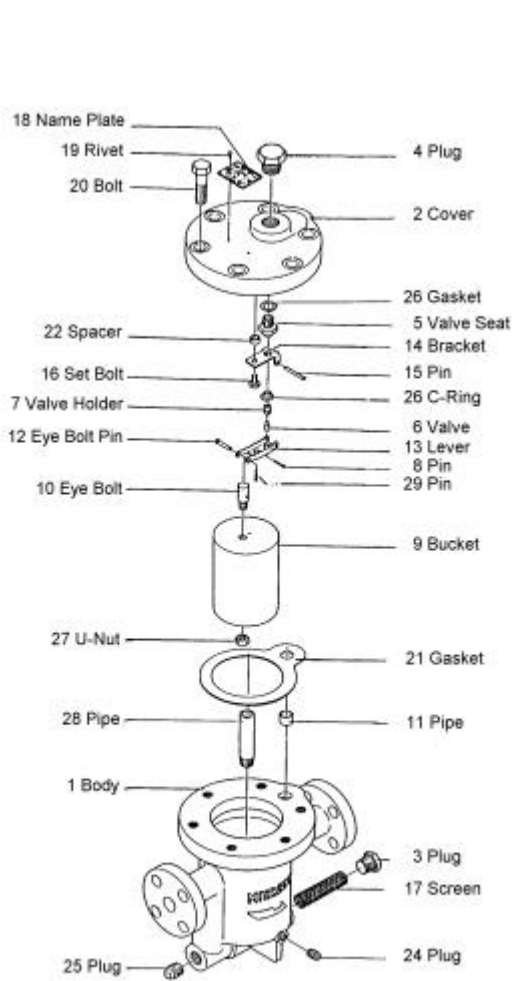

Capacity Chart

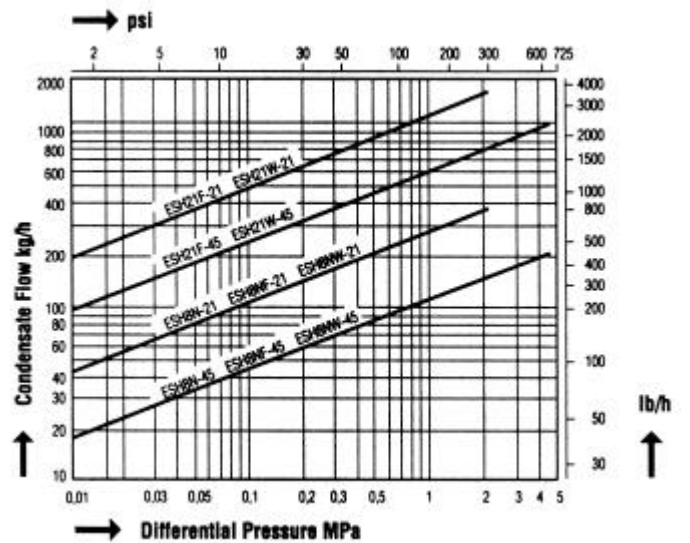

Materials

Parts-No.	Name	Material JIS/ASTM
1	Body	SCPH2
2	Cover	SCPH2
5	Seat	SUS 304 + STL
6	Valve	STL No. 6B
7	Valve holder	SUS 303
9	Bucket	SUS 304
17	Screen	SUS 304
20	Bolts	SNB7
21, 26	Gaskets	asbestos free