

Cast Steel Inverted Bucket Steam Trap

Features

1. Cast Steel body and stainless steel internals for high pressure applications.
2. Efficient energy conservation: will not leak live steam and prevents steam loss by the water seal inside the bucket.
3. No air and steam locking.
4. Very high durability by using the MIYAWAKI super lever and **SCCV** – System.
5. Withstands high back pressure (up to 90 % of the inlet pressure).
6. Withstands vibration.
7. Easy maintenance – all internal parts can be taken out together with the cover.

ESH8N

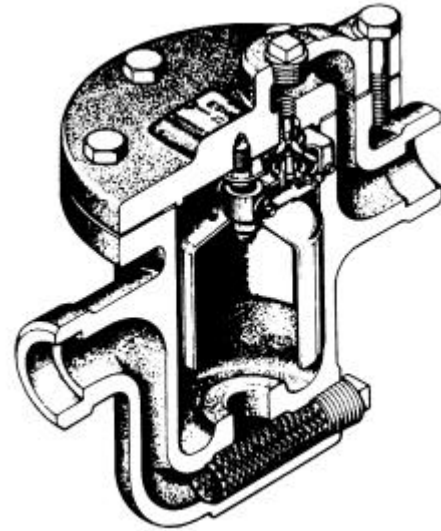

Operating Conditions & Dimensions

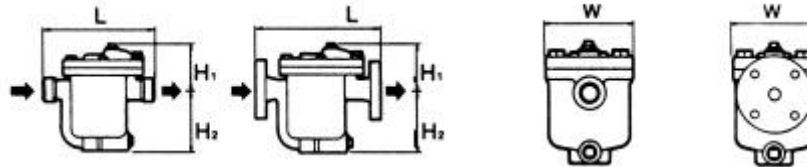

| Model | Conne- ction | Size | Operating Pressure Range | | Max. Operating Temperature | | Dimension mm (inch) | | | | Weight | |
|-----------|-----------------------------------|-------|--------------------------|------|----------------------------|-----|---------------------|----------------|----------------|--------------|--------|------|
| | | | MPa | psig | °C | °F | L | H ₁ | H ₂ | W | kg | lb |
| ESH8N-21 | screwed Rc, NPT | ½– 1" | 2,1 | 300 | 400 | 752 | 220 (8.7) | 103 (4.1) | 112 (4.4) | 146 (5.7) | 10,5 | 23.1 |
| ESH8N-45 | | | 4,4 | 640 | | | | | | | | |
| ESH8NF-21 | flanged JIS,ANSI DIN | ½– 1" | 2,1 | 300 | | | | | | | | |
| ESH8NF-45 | | | 4,4 | 640 | | | | | | | | |
| ESH8NW-21 | socket weld JIS,ANSI DIN | ½– 1" | 2,1 | 300 | | | 220 (8.7) | 103 (4.1) | 112 (4.4) | | 10,5 | 23.1 |
| ESH8NW-45 | | | 4,4 | 640 | | | | | | | | |

Cast Steel Inverted Bucket Steam Trap

ESH8N

Details

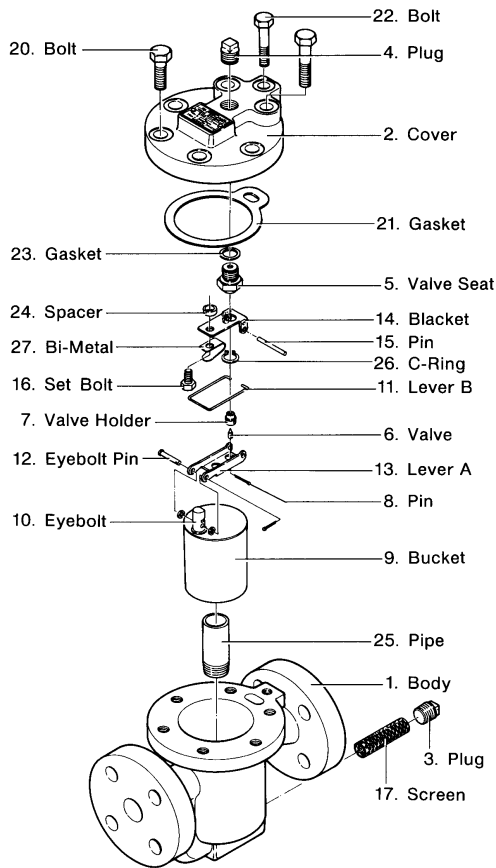

Capacity Chart

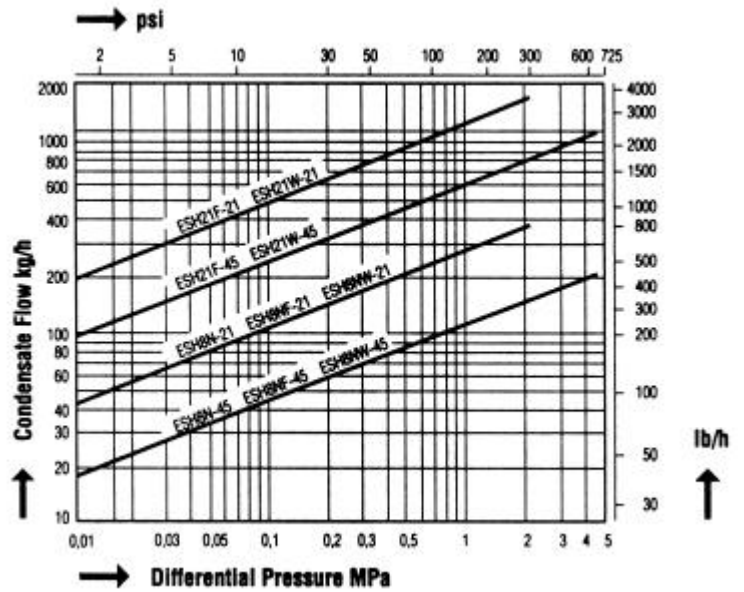

Materials

| Parts-No. | Name | Material JIS/ASTM |
|-----------|--------------|-------------------|
| 1 | Body | SCPH2 |
| 2 | Cover | SCPH2 |
| 5 | Seat | SUS 304 + STL |
| 6 | Valve | STL No. 6B |
| 7 | Valve holder | SUS 303 |
| 9 | Bucket | SUS 304 |
| 17 | Screen | SUS 304 |
| 20, 22 | Bolts | SNB7/S45C |
| 21, 23 | Gaskets | asbestos free |
| 27 | Bimetal | Special alloy |