

Cast Iron Ball Float Steam Trap

Features

1. Cast iron body and stainless steel internals.
2. High durability by using the MIYAWAKI Rolling valve (SCCV – System).
3. Inline reparability - all internal parts can be taken out together with the cover.
Quick discharge of air and gases at the time of start-up by using a membran type air vent.

G 11N / G 12N

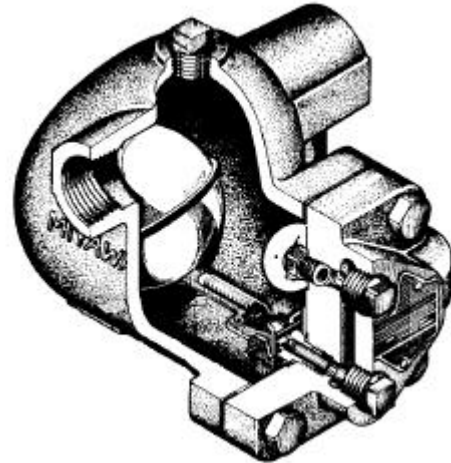

Operating Conditions & Dimensions

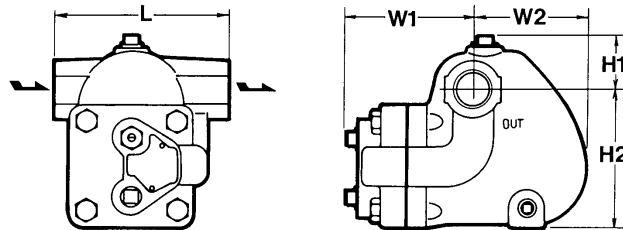

Model	Connec- tion	Size	Max. Operating Pressure		Max. Operating Temperature		Dimension mm (inch)					Weight			
			MPa	psig	°C	°F	L	H ₁	H ₂	W ₁	W ₂	kg	lb		
G 11N - 2	screwed Rc, NPT	½, ¾	0,2	29	220	428	120 (4.7)	37 (1.5)	92 (3.6)	97 (3.8)	60 (2.4)	3,9	8.6		
G 11N - 8			0,8	116											
G 11N - 16			1,6	230											
G 12N - 8		¾ 1"	0,8	116			140 (5.5)	47 (1.9)	113 (4.4)	102 (4.0)	92 (3.6)			5,9	13.0
			G 12N - 16	1,6											

Cast Iron Ball Float Steam Trap

Details

G 11N / G 12N

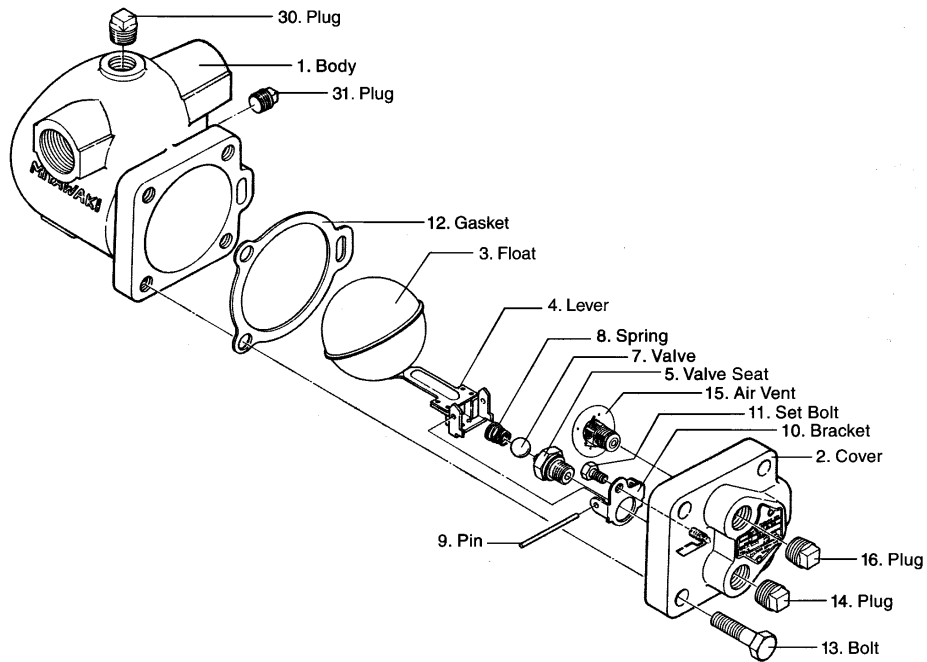

Capacity Chart

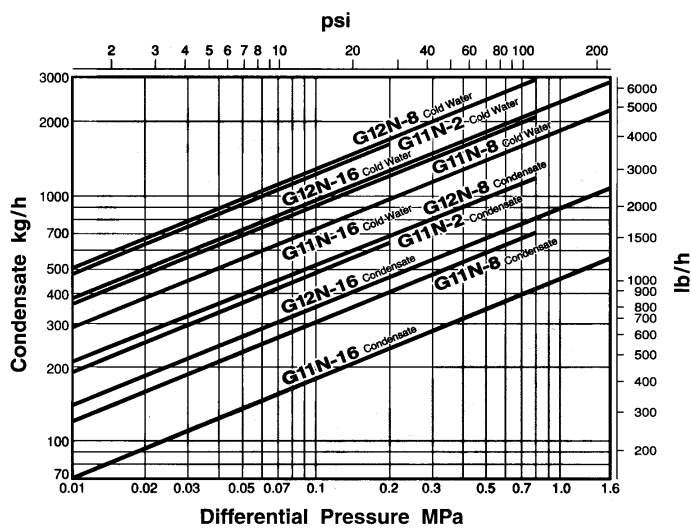

Materials

Parts-No.	Name	Material JIS/ASTM
1	Body	FC 250
2	Cover	FC 250
3	Float	SUS316L
4	Lever	SUS304
5	Seat	SUS403
6,12,18	Gaskets	asbestos free
13	Bolts	S45C