

Thermodynamic Disc Steam Trap

Features

1. Stainless steel body and stainless steel internals.
2. With bimetal ring for quick and efficient discharge of air and cold condensate upon start up.
3. Thermal insulation cover for energy conservation.
4. Inline repairability.
5. High durability.
6. For horizontal and vertical installation.

SU2N

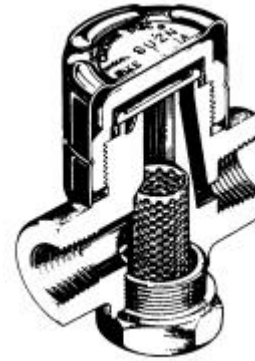

Operating Conditions & Dimensions

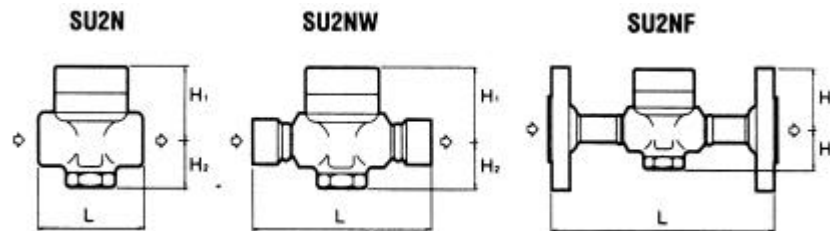

Model	Connection	Size	Operating Pressure Range		Max. Operating Temperature		Dimension mm (inch)				Weight					
			MPa	psig	°C	°F	L	H ₁	H ₂	W	kg	lb				
SU2N	screwed Rc, NPT	½"	0,15 - 4,6	22 - 667	425	800	70 (2.8)	45 (1.8)	32 (1.3)	53 (2.1)	0,8	1.8				
		¾"					47 (1.9)	35 (1.4)								
		1"					75 (3.0)	51 (2.0)								
SU2NW	socket weld JIS, ANSI, DIN	½"									120 (4.7)	45 (1.8)	32 (1.3)	53 (2.1)	1,0	2.2
		¾"								130 (5.1)	47 (1.9)	35 (1.4)	1,1		2.4	
		1"								140 (5.5)	51 (2.0)		1,4		3.1	
SU2NF	flanged JIS, ANSI	½"									205 (8.1)	45 (1.8)	32 (1.3)	53 (2.1)	1,8	4.0
		¾"								47 (1.9)		35 (1.4)	2,4		5.3	
		1"								51 (2.0)			3,0		6.6	
SU2NF	flanged DIN	½"					150 (5.9)	45 (1.8)	32 (1.3)	53 (2.1)	1,7	3.7				
		¾"				47 (1.9)	35 (1.4)	2,2	4.8							
		1"				160 (6.3)	51 (2.0)		2,8		6.2					

Thermodynamic Disc Steam Trap

SU2N

Capacity Chart

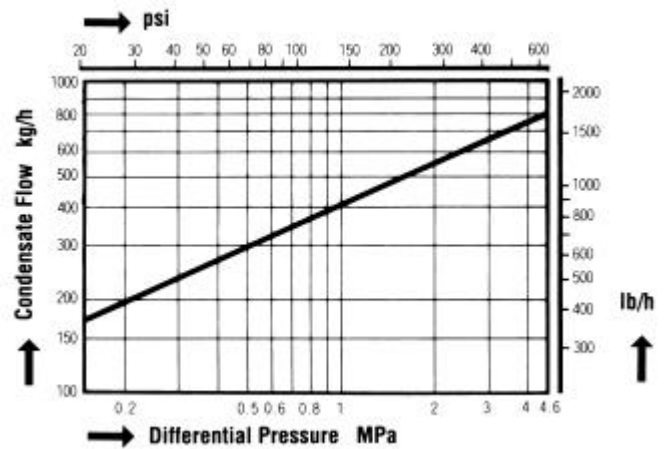

Details

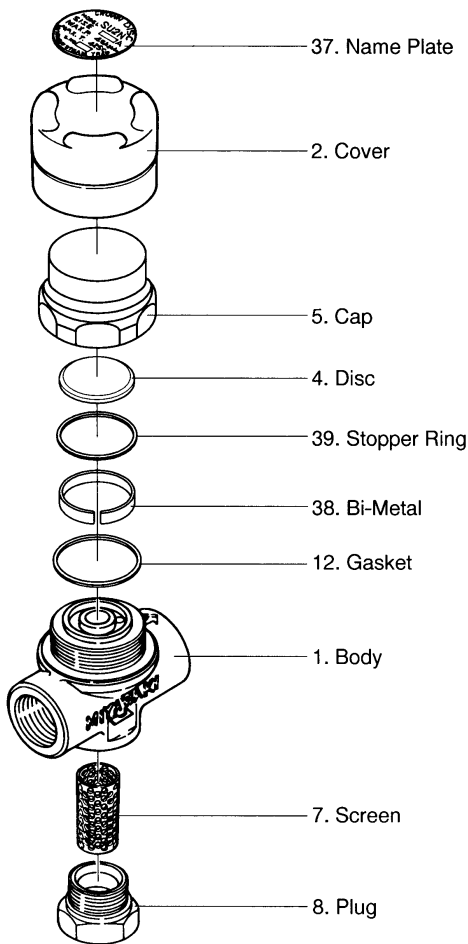

Materials

Parts-No.	Name	Material JIS/ASTM
1	Body	SUS420J2
2	Cover	SUS 304
4	Disc	SUS 420J2
5	Cap	SUS 403
7	Screen	SUS 304
8	Plug	SUS 403
12	Gasket	asbestos free
38	Bimetal	Special Alloy
39	Stopper ring	SUS 304